



SPECIFICATION FOR APPROVAL

Part name: EURO TERMINAL BLOCK

Part No.: JTB251-03

Customer P/N:

Date: 2008-10-28

Seller Confirmation

Written by	Tom.Zhang
Checked by	SJ.Fu
Approved by	Jim.Chen

Customer Confirmation

Project Audit	
Structure Audit	
Security Certification	
Quality Approval	

Seller: JITE Industrial (Shenzhen) Co., Ltd.

**Address : 13, ZaoHeKeng Area,JianKeng Road, JiXia
Community BuJi Street, ShenZhen 518114 China**

Tel: 0755-84509088

Fax: 0755-84509099

E-mail: kf1@jite.com.cn

Customer:

Customer P/N:

Seller: JITE Industrial(Shenzhen)Co.,Ltd

Part No: JTB251-03

Revision for JTB251-03

Item No	Edition	Part Revised	Date Revised
1	A	put in file	2008-10-28
2			
3			
4			
5			
6			
7			
8			
9			

1.TYPE: JTB251-03



2.DRAWING&SIZES

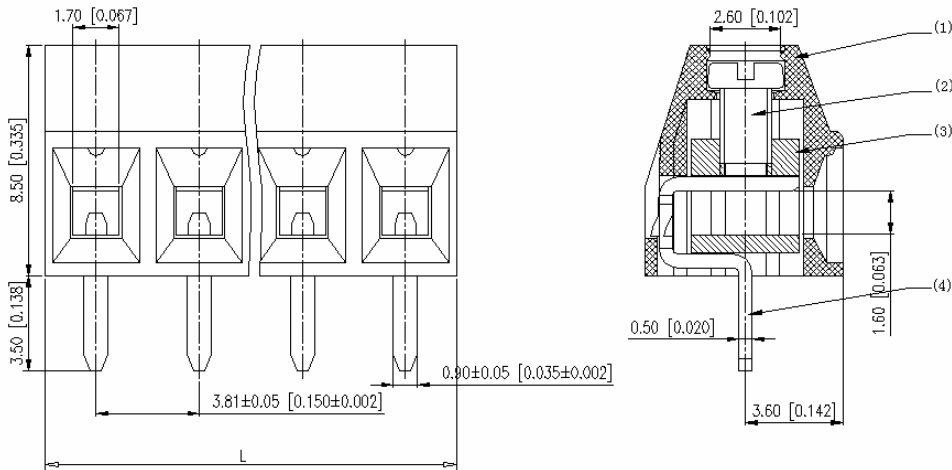

OVERALL SIZES

PCB HOLE DIMENSION

TOLERANCE:

> 120	±0.80
> 30~120	±0.50
> 6~30	±0.40
0~6	±0.25

3.BOM TABLE

ITEM.	PART NAME	MATERIAL	SURFACE OF CONTACT	QUANTITY(PCS)
(1)	BODY	PA66	/	1
(2)	SCREW	C1018	First,Cu Plated 1-2um Then Ni Plated 2-3um	N
(3)	BLOCK	Brass H62(Y2)	First,Cu Plated 1-2um Then Ni Plated 2-3um	N
(4)	TERMINAL	Brass H62(Y2)	First,Ni Plated 2-3um Then Sn Plated 5-8um	N

4. WIRE ENTRANCE: Parallel to PCB

PITCH: 3.81mm

WIRE RANGE: 16-30AWG

5. TECHNICAL DATA:

MAX. TORQUE: 2 .21bf.in

ELECTRICAL RATING: 300V, 10A

DIELECTRIC WITHSTAND: 1600V,1min

BREAKDOWN VOLTAGE: 2500V

INSULATION RESISTANCE: DC500V, More than500MΩ

6. WORKING CONDITION:

OPERATING TEMPERATURE: -40℃~+105℃

ALTITUDE: Less than 2000m 40Kpa~80KPa

RELATIVE HUMIDITY: 5%~95%

POLLUTION DEGREE: III

7. APPLICABLE STANDARDS

IEC 998-1 IEC 68-2-6 IEC 68-2-11 IEC 947-7-1

IEC 998-2-1 IEC 999 IEC 68-2-20 IEC 947

UL 1059 UL 486E CSA22.2 158-1987

8. PROCEDURE

This type of terminal blocks is connected with PCB by solder. If wave solder is applied in this procedure, the solder speed should be 260℃/5s twice and if manual solder is applied, the speed should be 350℃/10s. The connection way is as following.

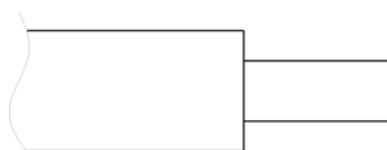

9. PACKAGE

Tightly Sealed